

HYPERPRO

STEERING DAMPER MOUNTING KIT

for

YAMAHA R1
Model '04 - '08

MK-YA10-0002 Rev.A PART LIST

SD stroke 75	1	-	-
Tube Clamp (MP-DB018235)	1	-	-
Spacer (MP-SP0001)	1	-	-
O-Ring	2	-	-
M8x30 Button head	1	-	-
M8x40 Button head	1	-	-
Washer M8 \varnothing 16	3	-	-
Lock-nut M8	1	-	-

ALL IDEAS, DESIGNS ARRANGEMENTS AND PLANS INDICATED OR REPRESENTED BY THIS DRAWING ARE OWNED BY HYPERPRO AND WERE CREATED, EVOLVED AND DEVELOPED FOR USE ON AND IN CONNECTION WITH THE SPECIFIC PROJECT. NONE SUCH IDEAS, DESIGNS, ARRANGEMENTS OR PLANS SHALL BE USED BY OR DISCLOSED TO ANY PERSON, FIRM OR CORPORATION FOR ANY PURPOSE WHATSOEVER WITHOUT THE WRITTEN PERMISSION OF HYPERPRO.

Damping adjustment knob:
- turn CW to increase damping,
- turn CCW to decrease damping.

Distance X=44mm

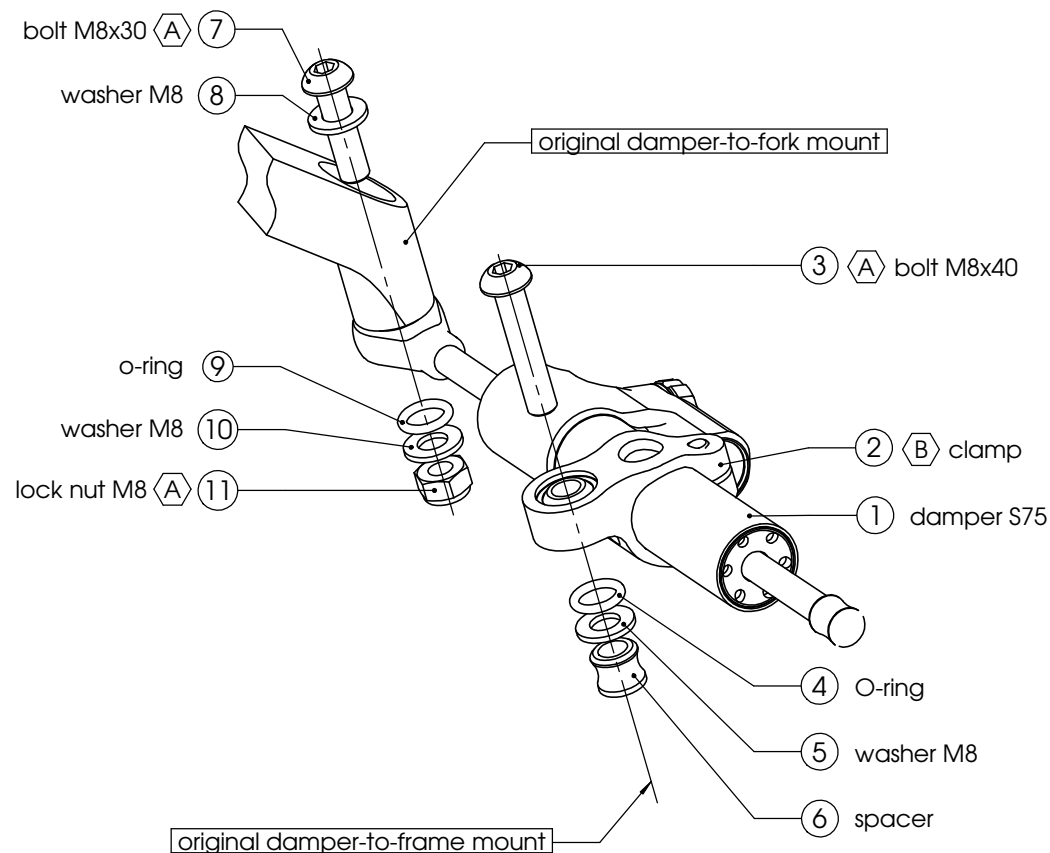
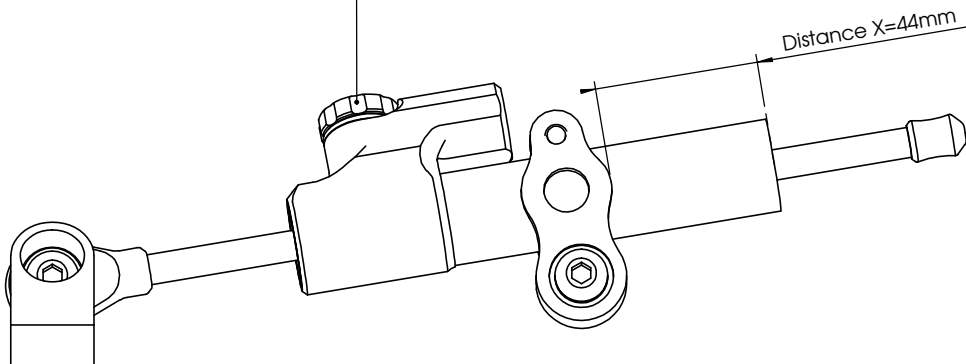

(A) 14-17Nm / 124-150Lbs.In / 10.3-12.5Lbs.Ft

(B) 6Nm / 53Lbs.In / 4.4Lbs.Ft

HYPERPRO

STEERING DAMPER MOUNTING KIT

for

YAMAHA R1 Model '04-'08

MK-YA10-0002 Rev.A INSTALLATION INSTRUCTIONS

In general:

HYPERPRO can not be held responsible in any way for any form of physical, material, financial or other damage arising from use, assembly or overhaul of HYPERPRO products. HYPERPRO reserves the right to make changes without prior notice.

This product is ONLY TO BE INSTALLED BY A PROFESSIONAL MECHANIC.

This product is only to be used for the motorcycle brand, model and year stated specifically on top of the pages of this manual.

DO NOT attempt to install this product on motorcycles from any different brand, model and/or year than stated on the pages of this manual.

DO NOT use this kit for cars, boats, jet-skies, snowmobiles, ATV's, aircraft, hovercrafts or any other vehicle and/or purpose.

HYPERPRO steering dampers are FOR RACE USE ONLY, NOT FOR HIGHWAY USE!

Before installation:

- Please read the entire manual carefully before starting the installation!
- Check if you have all the tools required. Good tools are a must.
- Protect your bike at the most important places in and around the work area (e.g. tank, fairing, frame, etc.), with a blanket, towel or similar.

During installation:

- Check all operations and parts carefully before, during and after performing each step.
- Clean all surfaces that are required for fitting parts together or for applying self adhesives or loctite, thoroughly with contact cleaner or another degreaser, unless otherwise stated.
- Be careful not to damage or scratch any part of your bike.
- ALWAYS work relaxed and concentrated!! It is very easy to damage something or make a mistake.

After installation:

- Check and make sure that there is no contact between any part of the steering damper kit and any part of the motorcycle. The kit should not hit anything. Steering movement should not be limited by the steering damper. If the steering movement is limited, adjust the position of the tube in the clamp until steering movement is normal again. Do not forget to tighten the clamp bolt again!
- ALWAYS check the steering movement and feeling before each ride !
- FIRST RIDES: Start with the damper turned fully open (turn adjuster knob fully counter clockwise). Start adjusting in between rides with steps of MAX. 2 CLICKS (0.25 TURN) EACH TIME, until the damper is working satisfactory for your riding style.
- NEVER USE MAXIMUM SETTING, ALWAYS OPEN AT LEAST 2 CLICKS (0.25 TURN).
- WARNING ! DAMPER HAS AN ACTIVE / SPEEDSENSITIVE DAMPING SYSTEM;
 - Steering with NORMAL MOVEMENT should be FREE !!
 - Steering with FAST MOVEMENT should be CONTROLLED BY DAMPER !!
- HYPERPRO uses a special seal to reduce friction. The seal uses an oil film to work properly. It is normal that some oil can appear on the pistonrod.
- Damper works with oil: DAMPING CAN BE HARDER AT LOWER TEMPERATURES!

Step 1: REMOVE the original steering damper!

Step 2: damper and clamp pre-assembly

Pre-assemble the damper and clamp bracket using:

- Steering damper Stroke 75mm (1)
- Damper clamp Type1 (2)

Put the assembly together as shown on page 1: Place the damper through the clamp at the distance as shown. Rotate the damper body a bit down.

Tighten the bolt with a torque of approx. 5-9Nm/44-80Lbs.In/4.0-6.4Lbs.Ft.

Step 3: installing to the frame

Install the fork bracket pre-assembly using:

- Bolt M8x40 (3)
- 1x O-ring (4)
- Washer M8 Ø 16 (5)
- Spacer Type1 (6)

Place the bolt (3) through the clamp (2) and position in the cockpit of the bike.

Use the O-ring (4) washer (5), and spacer (6) to fit the clamp correctly to the original M8 hole.

Tighten the bolt with a torque of approx. 14-17Nm/124-150Lbs.In/10.3-12.5Lbs.Ft.

Step 4: installing to the fork

Install the steering damper to the fork using:

- Bolt M8x30 button-head (7)
- 2x Washer M8 Ø 16 (8 & 10)
- 1x O-ring (9)
- 1x Lock-nut M8 (11)

Move the ball joint of the damper over the fork mounting hole. Place the bolt (7) and washer (8) on top of the bracket, through the damper head. Place the O-ring (9), washer (10) and M8 nut (11) on the bottom of the bolt. Tighten with a torque of approx. 14-17Nm/124-150Lbs.In/10.3-12.5Lbs.Ft. Check if the damper is level horizontally and aligned to the bike. Check if the damper does not touch anything when steering from left to right. Check if the bike can make it's full steering angle from left to right.

If necessary, loosen the clamp bolt (2), reposition the damper then tighten the clamp bolt (2) again with a torque of approx. 6Nm/53Lbs.In/4.4Lbs.Ft. Check movement again.