

# HYPHERPRO

## STEERING DAMPER MOUNTING KIT

for

### YAMAHA FZ-1 Fazer 1000 Model 2001 ->

#### MK-YA10-T006 PART LIST

SD stroke 75 'reversed'	1	M6x25 Low head	1
Tube Clamp TYPE 3	1	M6x30	2
O-Ring	2	M8x35 Button head	1
CNC Fork Bracket	1	M8x65	2
Tank Bracket Pt.1	1	Washer M6 Ø 12	1
Tank Bracket Pt.2	1	Washer M8 Ø 16	1
Tank Bracket Pt.3	1	Spacer Type 1	1
Tank Bracket Pt.4	1	-	-

ALL IDEAS, DESIGNS ARRANGEMENTS AND PLANS INDICATED OR REPRESENTED BY THIS DRAWING ARE OWNED BY HYPERPRO AND WERE CREATED, EVOLVED AND DEVELOPED FOR USE ON AND IN CONNECTION WITH THE SPECIFIC PROJECT. NONE SUCH IDEAS, DESIGNS, ARRANGEMENTS OR PLANS SHALL BE USED BY OR DISCLOSED TO ANY PERSON, FIRM OR CORPORATION FOR ANY PURPOSE WHATSOEVER WITHOUT THE WRITTEN PERMISSION OF HYPERPRO.

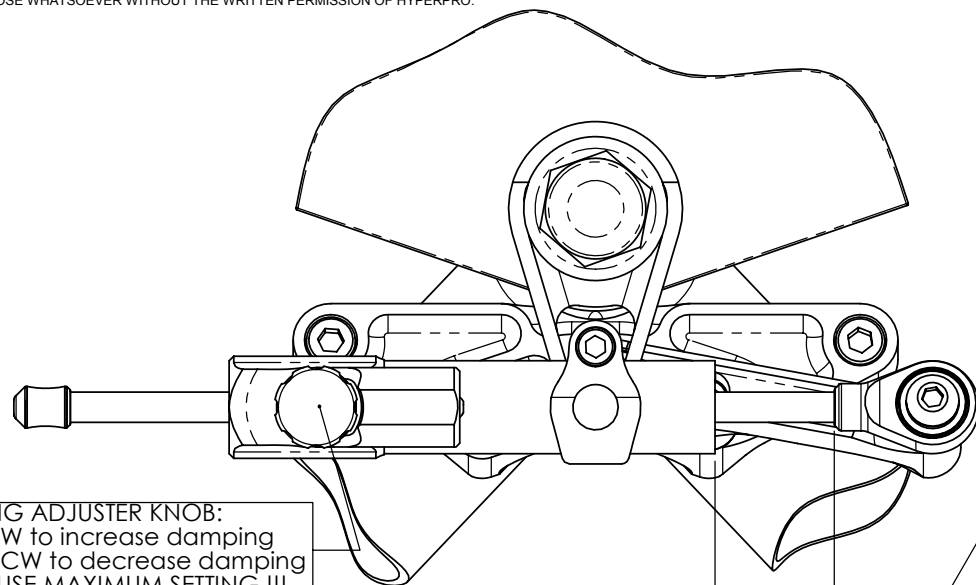

**DAMPING ADJUSTER KNOB:**  
- turn CW to increase damping  
- turn CCW to decrease damping  
**NEVER USE MAXIMUM SETTING !!!**

Keep at least 2mm clearance at full steering lock right

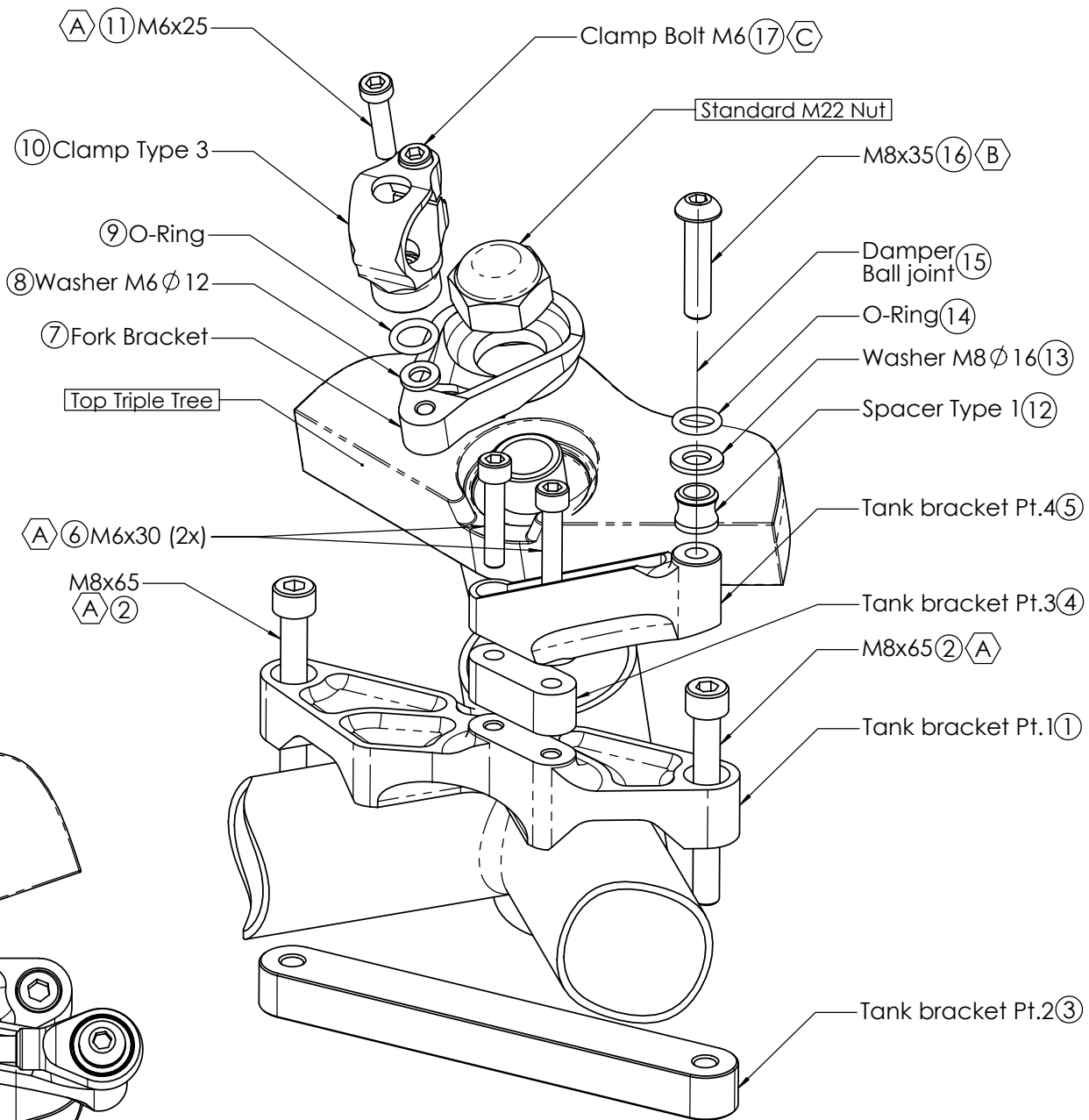

1  
of 2

(A) 14-17Nm / 124-150Lbs.In / 10.3-12.5Lbs.Ft  
 (C) 5-9Nm / 44-80Lbs.In / 4.0-6.4Lbs.Ft  
 (B) 6Nm / 53Lbs.In / 4.4Lbs.Ft

See [WWW.HYPERPRO.COM](http://WWW.HYPERPRO.COM) for the latest pictures, modifications, specs. and e-drawings of this steering damper kit.

# HYPERPRO

## STEERING DAMPER MOUNTING KIT

for

### YAMAHA FZ-1 Fazer 1000 Model 2001 ->

#### MK-YA10-T006 INSTALLATION INSTRUCTIONS

##### **In general:**

HYPERPRO can not be held responsible in any way for any form of physical, material, financial or other damage arising from use, assembly or overhaul of HYPERPRO products. HYPERPRO reserves the right to make changes without prior notice.

This product is ONLY TO BE INSTALLED BY A PROFESSIONAL MECHANIC.

This product is only to be used for the motorcycle brand, model and year stated specifically on top of the pages of this manual.

DO NOT attempt to install this product on motorcycles from any different brand, model and/or year than stated on the pages of this manual.

DO NOT use this kit for cars, boats, jet-skis, snowmobiles, ATV's, aircraft, hovercrafts or any other vehicle and/or purpose.

HYPERPRO steering dampers are FOR RACE USE ONLY, NOT FOR HIGHWAY USE!

##### **Before installation:**

- Please read the entire manual carefully before starting the installation!
- Check if you have all the tools required. Good tools are a must.
- Protect your bike at the most important places in and around the work area (e.g. tank, fairing, frame, etc.), with a blanket, towel or similar.

##### **During installation:**

- Check all operations and parts carefully before, during and after performing each step.
- Clean all surfaces that are required for fitting parts together or for applying self adhesives or loctite, thoroughly with contact cleaner or another degreaser, unless otherwise stated.
- Be careful not to damage or scratch any part of your bike.
- ALWAYS work relaxed and concentrated!! It is very easy to damage something or make a mistake.

##### **After installation:**

- Check and make sure that there is no contact between any part of the steering damper kit and any part of the motorcycle. The kit should not hit anything. Steering movement should not be limited by the steering damper. If the steering movement is limited, adjust the position of the tube in the clamp until steering movement is normal again. Do not forget to tighten the clamp bolt again!
- ALWAYS check the steering movement and feeling before each ride!
- FIRST RIDES: Start with the damper turned fully open (turn adjuster knob fully counter clockwise). Start adjusting in between rides with steps of MAX. 2 CLICKS (0.25 TURN) EACH TIME, until the damper is working satisfactory for your riding style.
- NEVER USE MAXIMUM SETTING, ALWAYS OPEN AT LEAST 2 CLICKS (0.25 TURN).

- WARNING ! DAMPER HAS AN ACTIVE / SPEEDSENSITIVE DAMPING SYSTEM;
  - Steering with NORMAL MOVEMENT should be FREE !!
  - Steering with FAST MOVEMENT should be CONTROLLED BY DAMPER !!
- HYPERPRO uses a special seal to reduce friction. The seal uses an oil film to work properly. It is normal that some oil can appear on the pistonrod.
- Damper works with oil: DAMPING CAN BE HARDER AT LOWER TEMPERATURES!

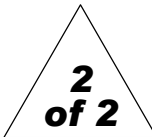

##### **Step 1: installing the tank bracket**

- Tank bracket part 1 (1)
- 2x Bolt M8x65 (2)
- Tank bracket part 2 (3)
- Tank bracket part 3 (4)
- Tank bracket part 4 (5)
- 2x Bolt M6x30 (6)

Place part 1 (1) on top of the frame in front of the tank, against the steering head. Place Tank bracket part 2 (3) underneath the upper frametubes. Make sure that there are no cables between the brackets and the frame! Connect bracket parts 1&2 (1, 3) using the 2 M8x65 bolts (2). Tighten the bolts with a torque of approx. 5-9Nm/44-80Lbs.In/4.0-6.4Lbs.Ft. Mount bracket parts 3&4 (4, 5) on part 1 (1) using the 2 M6x30 bolts (6), as shown on page 1. Tighten the bolts with a torque of approx. 5-9Nm/44-80Lbs.In/4.0-6.4Lbs.Ft.

##### **Step 2: fork bracket pre-assembly**

- Fork bracket (7)
- Washer M6 Ø 12 (8)
- 1x O-Ring (9)
- TubeClamp TYPE 3 (10)
- Bolt M6x25 Low head (11)

Put the assembly together as shown on page 1: Take the fork bracket (4), place the washer (5), the O-ring (6) and the tube clamp (7) inline on top of the M6 hole and put the M6 bolt (8) through all the parts and screw it into the thread of the bracket. Tighten the bolt with a torque of approx. 5-9Nm/44-80Lbs.In/4.0-6.4Lbs.Ft.

##### **Step 3: installing the fork bracket**

- Fork bracket pre-assembly

Loosen and remove the M22 steering stem nut, using a 30mm key. Remove standard washer. Place the assembly over the thread and in the pocket. Replace the nut on top of the forkclamp and tighten carefully with a torque of approx. 55-75Nm/486-663Lbs.In/40-55Lbs.Ft.

##### **Step 4: installing the steering damper**

- Spacer Type 1 (12)
- Washer M8 Ø 16 (13)
- 1x O-ring (14)
- Steering damper (15)
- Bolt M8x35 button head (16)

Ensure that the clamp bolt of the Tube clamp is pointing forward. Shove the damper (15), with the ball joint side first, through the clamp until the ball joint can be fitted to the tank bracket. Use the spacer (12), washer (13), O-ring (14) and M8 bolt (16) to fixate the balljoint (15a) to the tank bracket and tighten with a torque of approx. 14-17Nm/124-150Lbs.In/10.3-12.5Lbs.Ft.

Carefully steer fully to the right. Adjust the position of the tube so there is at least 2mm of space between the endcap and the balljoint, then tighten the M6 clamp bolt (17) with a torque of approx. 6Nm/53Lbs.In/4.4Lbs.Ft. Makes sure the distance "X" stated on page 1 is reached is more as 12 mm.

Check if the damper is level horizontally and aligned to the bike. Check if the damper does not touch anything (e.g. tank) when steering from left to right. Check if the bike can make it's full steering angle from left to right.

**See [WWW.HYPERPRO.COM](http://WWW.HYPERPRO.COM) for the latest pictures, modifications, specs. and e-drawings of this steering damper kit.**